

MPavilion
Parkville



Venue Hire
+ Events

We acknowledge and pay respect to the Traditional Owners of the lands upon which our campuses are situated.



Thanks to a generous philanthropic cultural gift from the Naomi Milgrom Foundation, University of Melbourne students, academics, and the communities within the City of Melbourne are welcomed to MPavilion Parkville. Designed by Glenn Murcutt AO, MPavilion Parkville was relocated from its temporary site in Queen Victoria Gardens to University Square, Carlton with assistance from the Naomi Milgrom Foundation.

MPavilion Parkville hosts a rich annual program of cultural events, lively talks, performances and workshops. It is available to the University and wider community as a vibrant space for hire in the heart of the University precinct.



Venue Hire Details

Hours of use:

Daytimes: Monday to Sunday, 7.30am-5pm

Evenings: Monday to Sunday, 5pm-late

Capacity:

Up to 95

Included AV & Furniture:

Portable speaker and microphone

Hearing assist

100 x red 'Bora' chairs

8 x white 'Bora' stools

Additional - on request. Please note that use of the below equipment requires an onsite AV Technician, which can be arranged through the Museums & Collections Events Team.

65" screen

2 x PA speakers

2 x handheld mics

Lectern

Additional furniture and AV equipment may be arranged by the hirer with approval from the Museums & Collections Events Team to ensure compliance with OH&S requirements. Third party deliveries and collections are to be managed by the hirer.

Venue Hire and Servicing Fees

Half Day Hire: \$500

Full Day Hire: \$800

Evening and Weekend Hire: from \$950

Rates include exclusive space hire, access to available furniture and assets, administrative support and an onsite site visit. Additional site inspections may require additional fees.

Are you a University of Melbourne hirer?

Please speak to the Museums & Collections Events Team to find out about applicable discounts.

Hire Period

The 'hire period' is 2 hours prior to the start time of the event and 1 hour post. Any set up and deliveries are to take place within your hire period. If the hire period needs to be extended to accommodate additional time for set up or equipment delivery, this can be negotiated with the Museums & Collections Events Team, and additional fees may be incurred.

Access

Please note that the grounds of University Square that surround MPavilion Parkville are managed by the City of Melbourne, and additional permits are required for any organised activity that spills over onto these grounds.

Loading to MPavilion Parkville is via Leicester Street, where cars may park and load equipment to the site via trolley. Please note there is no reserved parking available unless a permit is obtained by the City of Melbourne. A City of Melbourne permit is also required for vehicle access onto University Square.

Facilities

Please note there are no sanitary facilities at MPavilion Parkville or University Square. The closest sanitary facilities are located at the Alan Gilbert Building, 161 Barry St Carlton. These are accessible 7am-9pm on weekdays and 8.15am-5.45pm on weekends.

There is no running water available at the site.

As an outdoor venue, inclement weather should be considered when booking this venue. The structure has built-in blinds around the perimeter that can enclose the space. These will automatically retract in cases of high winds.

Free WiFi is available to University of Melbourne staff and students on the University of Melbourne wireless network.

Site Plan

28m x 9.4m

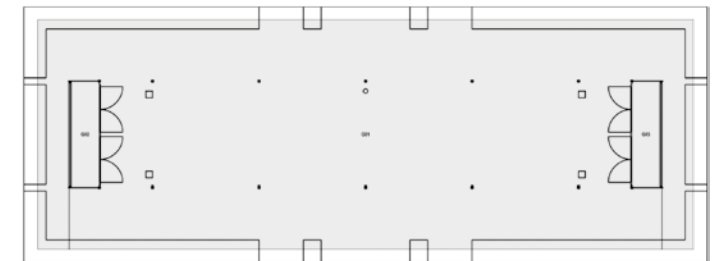

Please speak to the Museums & Collections Events Team about recommended seating configurations.

Contact
mc-events@unimelb.edu.au
to arrange a site visit
and get planning!



Take a look at some of our other fantastic venues available for your next event:

- [Ian Potter Museum of Art](#) (Reopening 2024)
- [Buxton Contemporary Art Museum](#)
- [Old Quad](#)
- [Science Gallery Melbourne](#)
- [Grainger Museum](#)

MPavilion
Parkville

MPavilion Parkville
University Square, Carlton, VIC 3053

